

FARRINGDON POINT

LONDON EC1

6,000 sq ft new CAT A+ fit out available in a prominent remodelled building

[PLAY FILM](#)



A POINT OF INSPIRATION



FARRINGTON POINT EC1

The 3rd floor at Farrington Point provides 5,908 sq ft of brand-new, plug & play office space directly opposite Farrington Station. This comprehensively refurbished space features an architecturally designed fit out by Spratleys, along with a new reception and external cladding. The office benefits from excellent natural daylight, air conditioning and modern amenities including showers and bike storage.





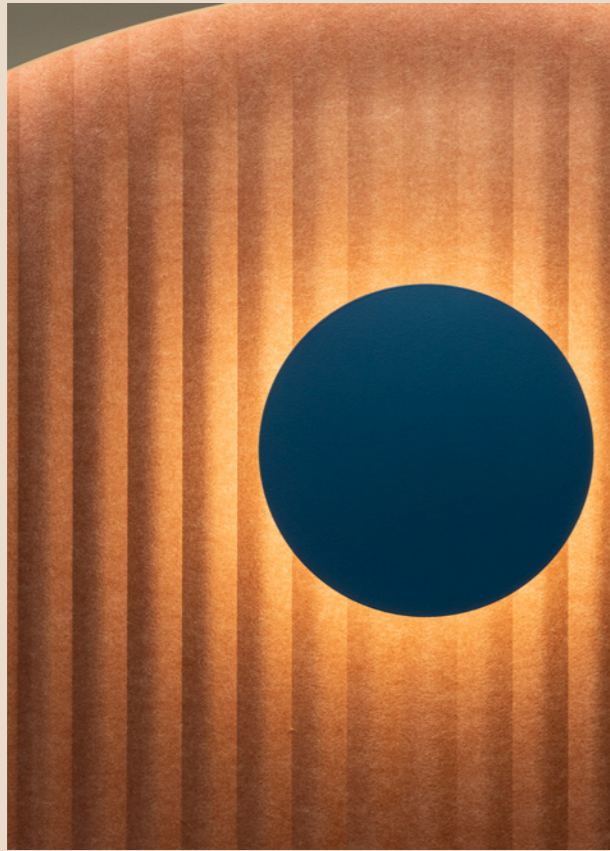

ON POINT SPEC



COMPREHENSIVELY
REFURBISHED



FULLY FITTED



AIR CONDITIONING



SHOWERS & BIKE STORAGE



EXCELLENT
NATURAL LIGHT



LOCATED NEXT TO
FARRINGDON STATION



NEW MANNED RECEPTION



PASSENGER LIFT









THIRD FLOOR

5,908 SQ FT / 549 SQ M

50	Workspaces
10	Agile workspaces
5	Multi-purpose spaces
8	Booth spaces
2	Large meeting rooms
1	Small meeting room
4	Video call booths
1	Reception
1	Kitchen
3	Breakout areas

FARRINGTON POINT EC1

- WORKSPACE
- MEETING ROOMS
- KITCHEN
- RECEPTION

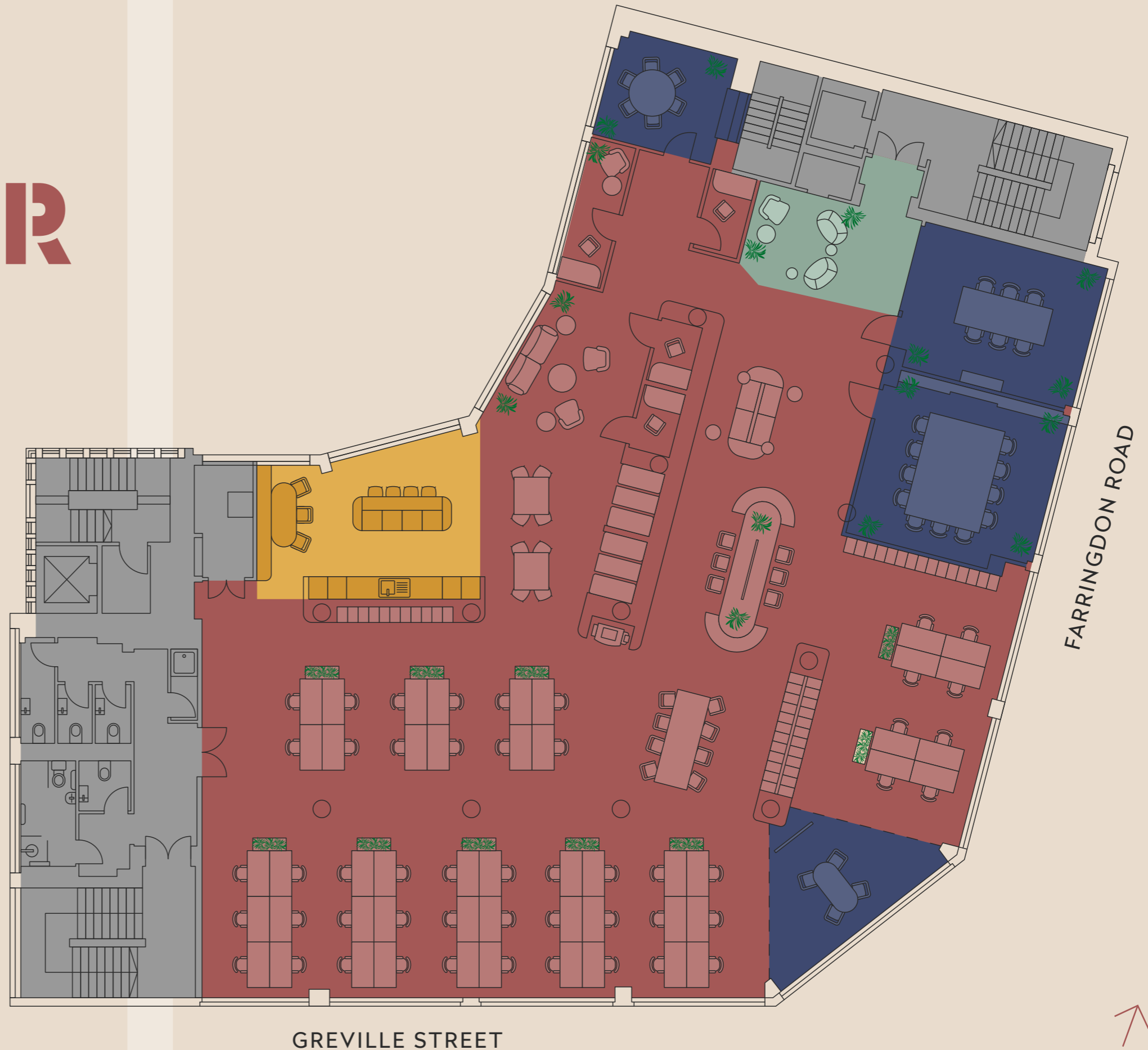





FARRINGTON POINT EC1





CENTRAL POINT

The surrounding area is vibrant and home to a mix of creative office occupiers, independent shops, cafés, bars and restaurants. A short stroll away, Leather Lane boasts its famous daily street food market, while the Culture Mile and upcoming New London Museum add to the area's growing dynamic appeal. The property is prominently positioned just moments from Farringdon Station which is served by the Elizabeth Line, Underground and Thameslink services.





RESTAURANTS

1. Vinoteca
2. Buy & Bite
3. Brutto
4. Farmer J
5. Origin City
6. Laksa
7. Balfour St Barts
8. Apulia
9. The Drunken Butler
10. Drip
11. Alfonsina
12. 1920 Bar
13. Sessions Arts Club
14. KIN
15. Leather Lane Market
16. The Salad Kitchen
17. Mugen
18. Camino
19. Luca
20. Dan le Noir ?
21. Le Café du Marché
22. St. John
23. Bouchon Racine
24. Bleeding Heart Bistro
25. Dal Fiorentino
26. Vivat Bacchus
27. Club Gascon
28. Ceru

HOTELS

1. Avari Apartments
2. The Zetter

BARS

1. Hope Smithfield
2. Space Talk
3. Smiths of Smithfield
4. Brewdog
5. Hat & Tun
6. The Holy Tavern
7. Piano Works
8. The Clerk & Well
9. The Craft Beer Co.
10. The Crown Tavern
11. The Slaughtered Lamb
12. The Argyle
13. Fox & Anchor
14. Clerkenwell & Social
15. The Castle
16. 56 Wine Bar & Shop
17. The Fable

CAFÉS

1. Paul's
2. FWD: Coffee
3. Roni's Café
4. Bench Café
5. Fidelio

GYMS

1. Gymbox
2. Crossfit Farringdon
3. PureGym
4. Restart Reformer Pilates

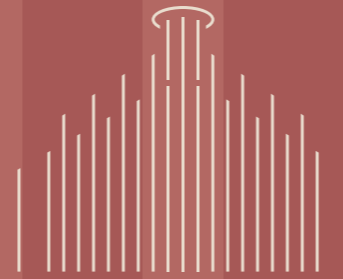

FARRINGDON POINT

LONDON EC1

 Hanover Green

Farebrother

GUY MILNE
07775 897919

gmilne@hanovergreen.co.uk

GEORGE BREWSTER
07745 606874

gbrewster@hanovergreen.co.uk

MATT CAUSER
07990 975969

mcauser@farebrother.com

HARVEY WIDDOWSON
07732 649308

hwiddowson@farebrother.com

Important notice relating to the Misrepresentation Act 1967 and the Property Misdescriptions Act 1991: (i) the particulars are set out as a general outline only for guidance of intending purchasers or lessees and do not constitute, nor constitute part of, an offer or contract (ii) all descriptions, dimensions, references to condition and necessary permission for use and occupation, and other details are given in good faith and are believed to be correct, but any intending purchasers or occupiers should not rely on them as statements or representations of fact, but must satisfy themselves by inspection or otherwise as to the correctness of each of them. April 2026

Marketing: [Stuart Chapman Design](#)